

SWIMMING POOL HEAT PUMP

SPHP 5~24



SWIMMING POOL HEAT PUMP

Indoor installation

Capacity from 5 to 24 KW

Characteristics

Dehumidify capacity: 4-27kg/h

Heat recovery from dehumidifying

Heating room air and pool water

Anti-corrosive design with special titanium co-axial heat exchanger and copper finned heat exchanger

Available configurations

SPHP 5 A 1
(1) (2)

(1) Refrigerants:

- A R22
- B R407C
- C R134a
- D R410A
- E Other refrigerants

(2) Power Supply:

- 1 220/1/50
- 2 380/3/50
- 3 230/1/60
- 4 460/3/60
- 5 220/3/60
- 6 Other power supply

Applications

Indoor swimming pool and dehumidification occasion

Functions and features



Heating only



Air cooled



Indoor inst.



Refrig. R-407C



Refrig. R-134a



Refrig. R-410A



Refrig. R-22



Herm. Scroll



Thermodynamic Heat Recovery

Optional
Electric heater
Fresh air
Blue fins

Technical data

Model	SPHP	Size	5	7	9	12	14	18	24	
Dehumidify capacity	kg/h		3.4	5.6	7.6	9.1	11.3	16.3	21.3	
Dehumidify capacity	kg/h		4.3	7	9.5	11.5	14.2	20.5	26.8	
Compressor	Type		Scroll							
	Nr.		1	1	1	1	1	1	1	
	Power input	KW	1.4	2.5	3.5	4	5.5	6.9	8.7	
	Oil		P.O.E.							
Refrigerant	Oil volume	L	1.5	1.5	2	2	2	3	4	
	Type		R407C							
	Weight	kg	2.1	3	3.5	4.5	5	6	7	
Power supply			220V/1P/50Hz						380V/3P/50Hz	
Fan	Type		Centrifugal							
	Nr.		1							
	Air flow	m ³ /h	1359	1869	2209	3228	3568	3908	5947	
	Maximum fresh air	m ³ /h	800	800	800	2000	2000	2500	3000	
Condenser	Power input	KW	0.55	0.55	1	1.5	1.5	3	3	
	Type		Fin coil							
	Material		Cu/Cu							
Evaporator	Type		Fin coil							
	Material		Cu/Cu							
Heat recovery	Type		Co-axial							
	Material		Titanium/Steel							
	Water flow	m ³ /h	0.9	1.2	1.5	2.1	2.3	3.1	4.1	
	Inlet/outlet nozzle	DN	20	20	20	20	20	25	25	
Resistance	KPa		18	21	22	23	24	24	25	
	External static pressure	Pa	110	110	150	150	150	180	180	
Noise	dB(A)		50	50	51	52	52	54	55	
Weight	kg		110	135	150	175	190	225	280	

Note:

Return air 27.8°C/50%RH.

Return air 27.8°C/60%RH.

Heat recovery water temperature difference 5°C.

Noise measured at 1m in open field.

Dimensions

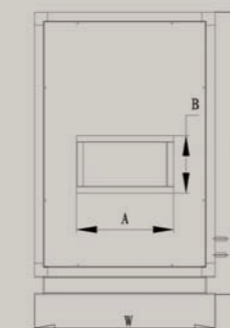
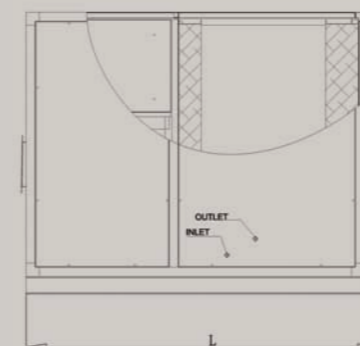

Size	5	7	9	12	14	18	24
L	800	800	800	835	835	1180	1180
W	820	820	820	990	990	1260	1730
H	1260	1260	1260	1430	1430	1540	1540
A	300	300	300	400	400	400	500
B	150	150	150	250	250	320	320